

Since the operating procedures for 04 Series are similar, this document will be based on CO-04.

Names for each part

1. Alarm lamp

2. Buzzer sound opening

3. LCD display

4. AIR button

5. POWER/MODE button

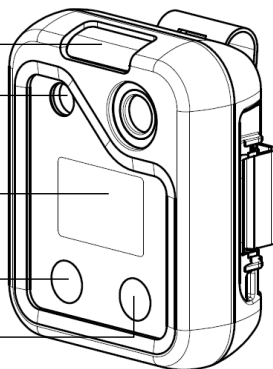

1. The red lamp blinks in response to an alarm.

2. Windows for operation and alarm sound.

3. Display the gas concentration and so on.

4. Perform the air calibration in measuring mode.

5. Turn on/off power.

How to use

1. How to start the gas monitor

Keep the POWER button pressed for three seconds or more. After the various information is displayed one by one, you will hear two beeps and then the detection mode is ready.

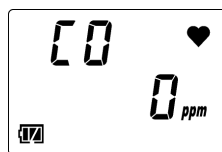
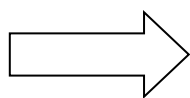

2. Preparation for start-up

2-1. Check the battery level

After the measurement screen is appeared, check the remaining battery level icon. If the remaining battery level is one or blinking, replace the batteries*.

*Refer to "5. Replacing the batteries".

Battery level icon

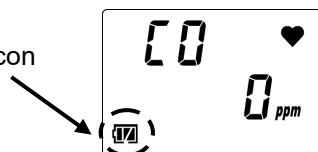

 : Sufficient

 : Low

 : Needs charging

If the battery level further drops, the battery icon starts blinking.

2-2. Check the filter

Please confirm that the dust filter attached to the sensor part at the upper right of the instrument is not dirty or clogged. If the filter is dirty, please replace it.

*For more details how to replace the filter, please refer to the instruction manual.

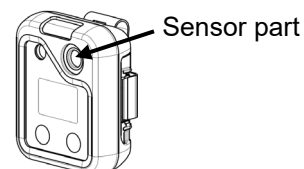

WARNING: If the filter is dirty or clogged, detection may not be performed accurately.

How to use

3. Air calibration

Perform an air calibration before measuring the gas concentration.
 Press and hold the Air button. Release it after the display shows "RELEASE" below. When the zero adjustment is successfully completed, and the reading value turns to zero (20.9% for O₂). If this operation is completed and the display shows the measurement screen, detection can be performed.



WARNING: If you do not carry out the process in fresh air, calibration would not be completed properly. This exposes you to danger when a gas leaks.

4. How to exit

Make the gas monitor draw in fresh air. After the display returns to zero (or 20.9vol% for oxygen), keep the POWER button pressed until the power is turned off.

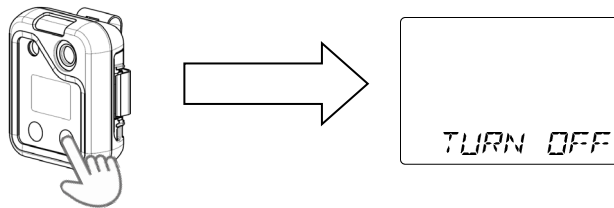

5. Replacing the batteries

Turn off the power, loosen the battery lid fixing screw with a flat head screwdriver, and open the battery lid.
 If the belt clip is installed, open the belt clip.

Remove the old batteries and insert a new one, taking care to note the polarity* of the batteries.

*The polarity of the battery is marked on the inside of the unit.

Close the battery lid and tighten the battery lid fixing screw with a flat head screwdriver.

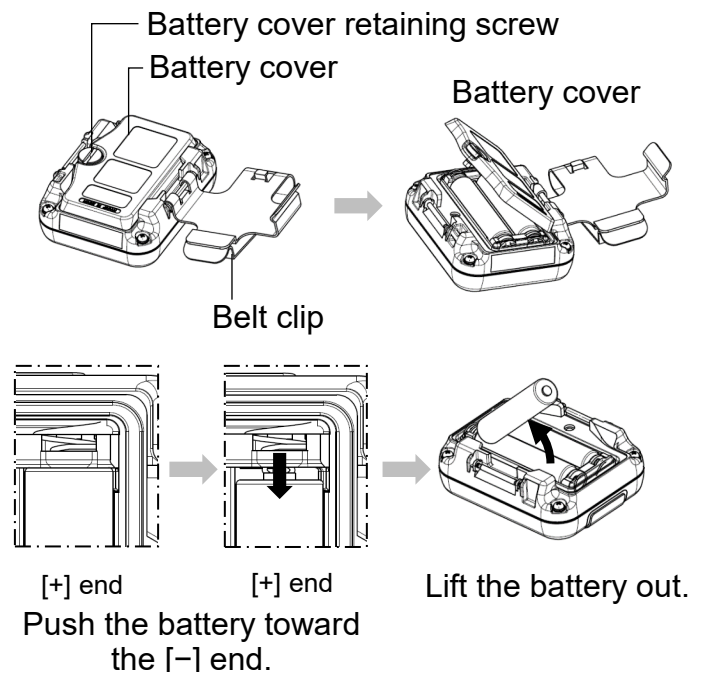

WARNING: Please charge or replace batteries in non-hazardous areas.